

27.714.\*

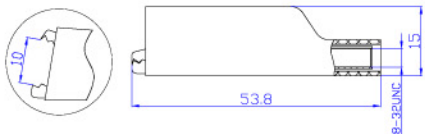

**Material**  
 Insulator:PVC  
 Body:Steel  
 Surface:Nickel plated



27.720.\*



**Material**  
 Insulator:PVC  
 Body:Steel  
 Surface:Nickel plated

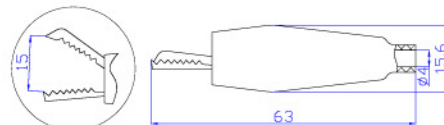

27.716.\*



**Material**  
 Body:Steel  
 Surface:Nickel plated  
**Current**  
 Max.10A

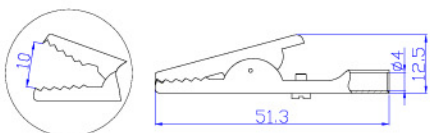

27.722.\*



**Material**  
 Insulator:PVC  
 Body:Steel  
 Surface:Nickel plated  
**Current**  
 Max.30A

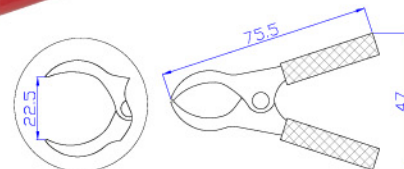

27.718.\*



**Material**  
 Insulator:PVC  
 Body:Steel  
 Surface:Nickel plated

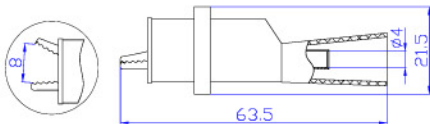

27.723.\*



**Material**  
 Insulator:PVC  
 Body:Steel  
 Surface:Nickel plated  
**Current**  
 Max.30A

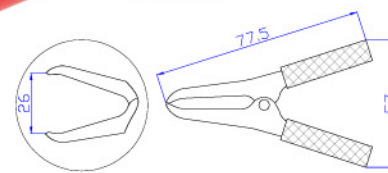

27.719.\*



**Material**  
 Insulator:ABS  
 Body:Steel  
 Surface:Nickel plated



27.211.\*



**Material**  
 Insulator:PVC  
 Body:Steel  
 Surface:Nickel plated  
**Current**  
 Max.50A

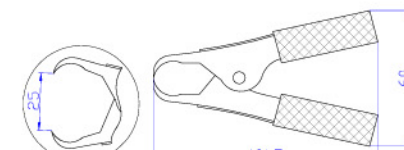

28.110



**Material**

Body: Brass  
Surface: Gold plated

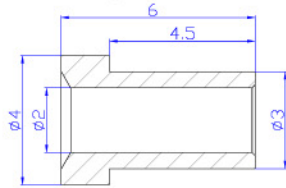

28.210



**Material**

Body: Brass  
Surface: Gold plated

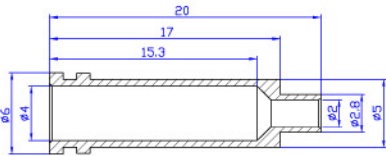

28.220



**Material**

Body: Brass  
Surface: Nickel plated

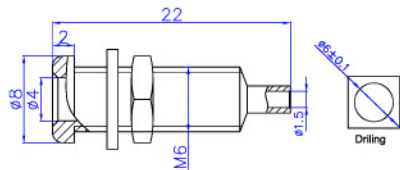

28.230



**Material**

Body: Brass  
Surface: Nickel plated

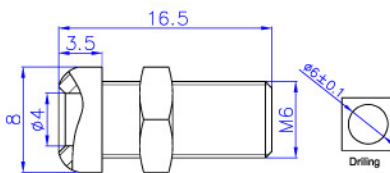

28.310



**Material**

Body: Brass  
Surface: Gold plated

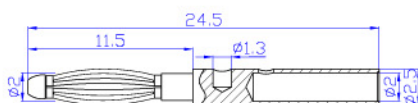

28.320



**Material**

Body: Brass  
Spring: Beryllium copper  
Surface: Gold plated

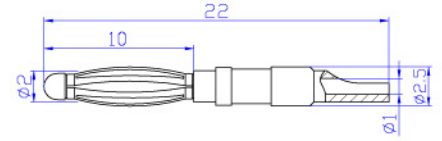

28.33\*



Item No.	T	L
28.330	M2.0	6.5
28.331	M2.5	6.5
28.332	M3.0	6.5

**Material**

Body: Brass  
Spring: Beryllium copper  
Surface: Gold plated

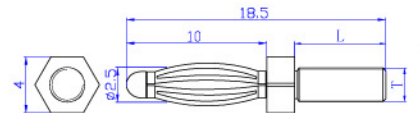

28.340



**Material**

Body: Brass  
Spring: Beryllium copper  
Surface: Gold plated

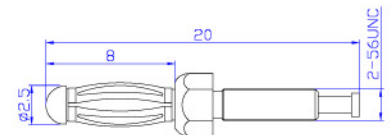

28.350



**Material**

Body: Brass  
Spring: Beryllium copper  
Surface: Gold plated

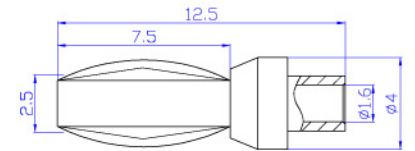

28.36\*



Item No.	T	L
28.360	M2.0	6.5
28.361	M2.0	10.0
28.362	M2.5	6.5

**Material**

Body: Brass  
Spring: Beryllium copper  
Surface: Gold plated

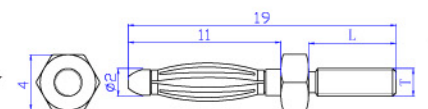

28.370



**Material**

Body: Brass  
Spring: Beryllium copper  
Surface: Nickel plated

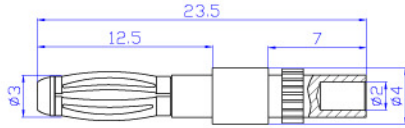

28.440



**Material**

Body: Brass  
Spring: Beryllium copper  
Surface: Nickel plated

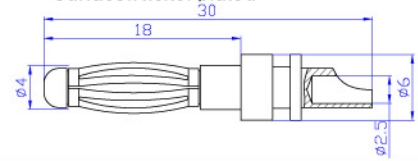

28.41\*



**Material**

Body: Brass  
Spring: Beryllium copper  
Surface: Nickel plated

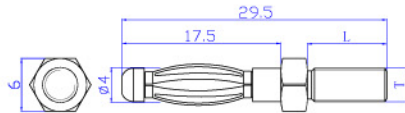

28.450



**Material**

Body: Brass  
Spring: Beryllium copper  
Surface: Nickel plated

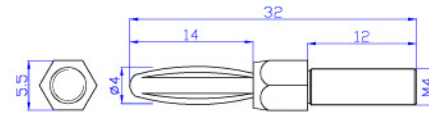

Item No.	T	L
28.410	M3.0	6.0
28.411	M3.0	10.0
28.412	M4.0	4.5
28.413	M4.0	6.0
28.414	M4.0	9.0
28.415	M4.0	18.0

28.46\*



**Material**

Body: Brass  
Spring: Beryllium copper  
Surface: Nickel plated

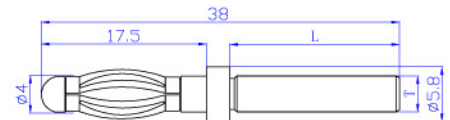

28.420



**Material**

Body: Brass  
Spring: Beryllium copper  
Surface: Gold plated

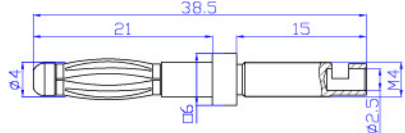

Item No.	T	L
28.460	M3.0	3.0
28.461	M3.0	6.5
28.462	M4.0	6.0
28.463	M4.0	9.0

28.430



**Material**

Body: Brass  
Spring: Beryllium copper  
Surface: Gold plated

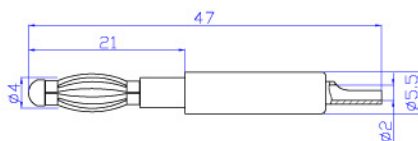

28.510



**Material**

Body: Brass  
Spring: Beryllium copper  
Surface: Nickel plated

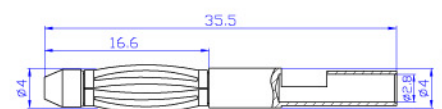

28.520

**Material**

Body: Brass  
Spring: Beryllium copper  
Surface: Nickel plated

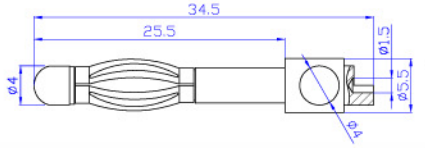

28.620

**Material**

Body: Brass  
Spring: Beryllium copper  
Surface: Silver plated

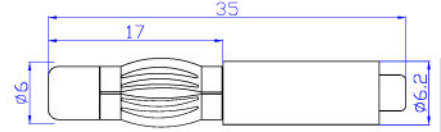

28.610

**Material**

Body: Brass  
Spring: Beryllium copper  
Surface: Gold plated

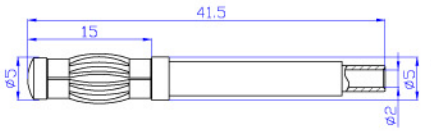

28.910

**Material**

Body: Copper  
Surface: Nickel plated

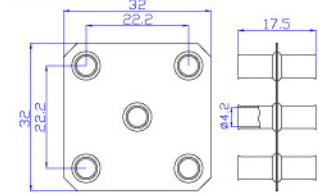

28.710

**Material**

Body: Brass  
Spring: Beryllium copper  
Surface: Nickel plated

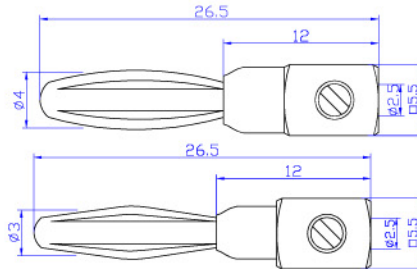

33.110



2 x 4mm safety test lead:[22.420](#)(1mm<sup>2</sup> JBF wire,L:100cm)  
2 x test probe:[20.164](#)  
2 x safety crocodile clips:[27.262](#)  
2 x test clip:[20.169](#)

33.120



2 x 4mm safety test lead:[22.420](#)(1mm<sup>2</sup> JBF wire,L:100cm)  
2 x test probe:[20.164](#)  
2 x safety crocodile clips:[27.262](#)  
2 x test probe:[20.168](#)

33.130



2 x 4mm safety test lead:[22.310](#)(1mm<sup>2</sup> JBF wire,L:100cm)  
2 x test probe:[20.164](#)  
2 x safety crocodile clips:[27.262](#)  
2 x test clip:[20.169](#)

33.140



2 x 4mm safety test lead:[22.280](#)(1mm<sup>2</sup> JBF wire,L:100cm)  
2 x test probe:[20.157](#)  
2 x safety crocodile clips:[27.262](#)  
2 x test clip:[20.169](#)

33.150



- 2 x 4mm safety test lead:[22.280](#)(1mm<sup>2</sup> JBF wire,L:100cm)
- 2 x 4mm test lead:[22.530](#)(0.75mm<sup>2</sup> PVC wire,L:25cm)
- 2 x test probe:[20.157](#)
- 2 x safety crocodile clips:[27.262](#)

33.310



- 2 x 4mm safety test lead:[22.280](#)(1mm<sup>2</sup> JBF wire,L:100cm)
- 2 x 4mm test lead:[22.370](#)(1mm<sup>2</sup> JBF wire,L:100cm)
- 2 x test probe:[20.157](#)
- 2 x safety crocodile clips:[27.262](#)
- 2 x test clip:[20.169](#)

★ Packed in the tool bag



33.320



- 2 x 4mm safety test lead:[22.280](#)(1mm<sup>2</sup> JBF wire,L:100cm)
- 2 x test probe:[20.157](#)
- 2 x test probe:[20.164](#)
- 2 x safety crocodile clips:[27.262](#)
- 2 x test clip:[20.169](#)
- 2 x connecting plug:[26.451](#)
- 2 x connecting plug:[26.456](#)

★ Packed in the tool bag



**35.900**

Choose the products from our catalogue and we will pack them into the tool bag as you want. Suitable for the small test kits with the test lead within 100CM.

- Feature:**
1. Five independent space of each bag
  2. Tool bag can hang on the wall or your belt
  3. Free logo space

**35.910**

Choose the products from our catalogue and we will pack them into the magic tool box as you want. Suitable for the medium test kits with the test lead within 200CM.

- Feature:**
1. Tool box can be divided into the different space with the plastic insert
  2. Tool bag can hang on the wall
  3. Free logo space

**35.911**

Choose the products from our catalogue and we will pack them into the magic tool box as you want. Suitable for the big test kits with the test lead within 500CM.

- Feature:**
1. Tool box can be divided into the different space with the plastic insert
  2. Tool bag can hang on the wall
  3. Free logo space

**35.920**

Choose the products from our catalogue and we will pack them into the tool box as you want. Suitable for the professional test kits.

- Feature:**
1. Special material to make the box that insure it can save in different working environment
  2. Foam-rubber cushion protect the inside products
  3. Free logo space

### Hex nut

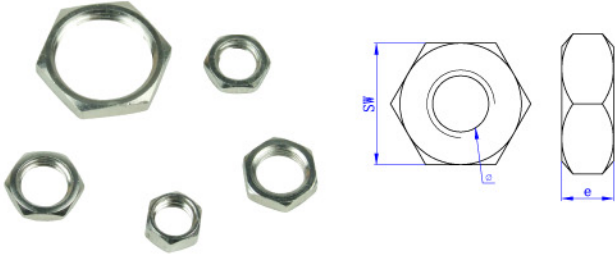

Item No.	T	e	s w
035.0005	M4	3	6
035.0010	M6	2	8
035.0014	M8	3	10
035.0023	M12	2.5	14

### Round nut

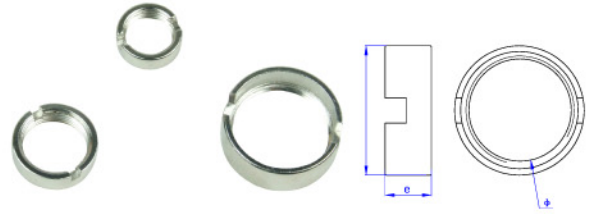

Item No.	T	e	φ
035.0039	M6	2.5	8
035.0029	M8	3	10
035.0030	M12	5	14

### Terminals



Item No.	W	L
023.0083	2.8	14
023.0084	4.8	15
023.0085	3.8	19

### LED Base

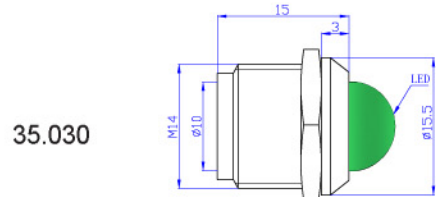
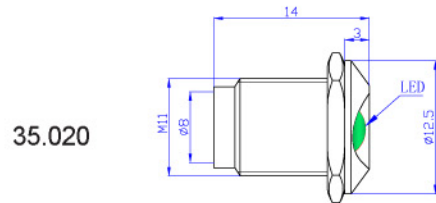
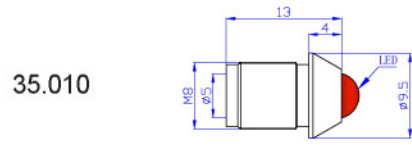

### Hex spacers

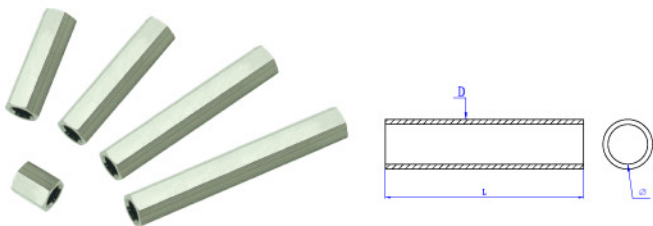

Item No.	φ	s w	L
023.0086	3	6	8
023.0087	3	6	20





Testing machine to collect the electrical data sheet about the products

- \* Current test
- \* Voltage test
- \* Safety test



Testing machine to collect the mechanical data sheet about the products

- \* Insert test
- \* Pull test



Testing machine to collect the mechanical data sheet about the cable

- \* Pull test
- \* Rotational test

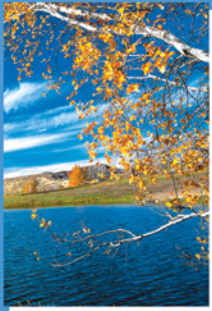

**Amass**®

**CHANGZHOU AMASS ELECTRONICS CO.,LTD.**

Add: Lijia Town, Wujin Dis. Changzhou City,  
Jiangsu Pro.China.

Postal Code: 213176

Tel: 86-519-86731695

Fax: 86-519-86735861

E-mail: [hzy@china-amass.com](mailto:hzy@china-amass.com)